



RTE0A

INSTALLATION

INSTRUCTIONS

WIRED DIGITAL ROOM THERMOSTAT

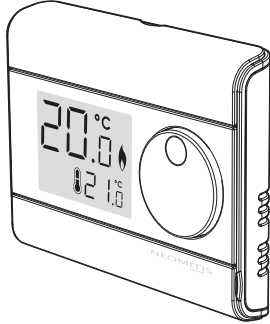
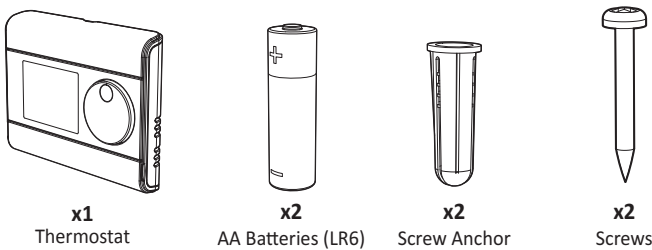

TABLE OF CONTENTS

Pack contains	1
Installation	1
Installing batteries.....	1
Mounting of wall mounting plate	1
Wiring	1
Mounting of the Thermostat.....	2
Troubleshooting	2
Technical specifications	2

PACK CONTAINS



INSTALLATION

Recommended locations for your thermostat.

To ensure that your thermostat provides accurate readings and controls effectively, it must be installed approximately 1.5 m above floor level on an inside wall, away from direct sunshine and any other sources of heat or cold such as radiators, cold draughts, etc.

Important: The thermostat measures the temperature of the place where it is installed. It does not take into account the temperature differences that may exist between different locations in the house if the temperature is not uniform.

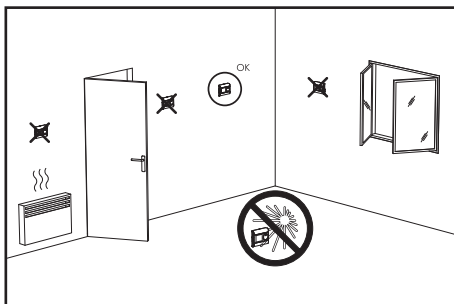

INSTALLING BATTERIES

1- Remove the batteries cover which is placed on the front of thermostat.

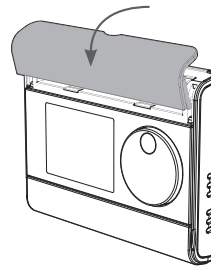

2- Insert the 2 batteries AA supplied. Note the correct polarity according to the engraving on the thermostat when inserting the batteries.

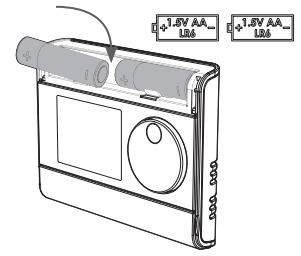

3- Replace the batteries cover.

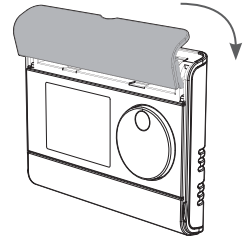

MOUNTING OF WALL MOUNTING PLATE

The digital room thermostat is fixed on the wall with the wall plate which is supplied with the product.

1- Unscrew the 2 screws under the thermostat.

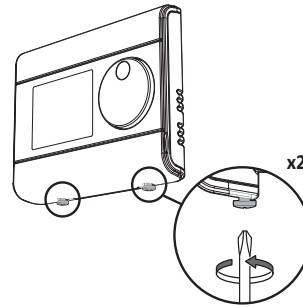

2- Remove the wall plate from the thermostat.

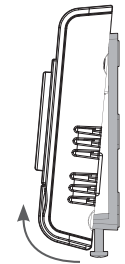

3- Secure the wall plate with the two screws provided using the horizontal and vertical holes.

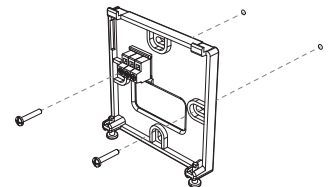

WIRING



All electrical installation work should be carried out by a suitably qualified Electrician or other competent person. If you are not sure how to install this thermostat consult either with a qualified electrician or heating Engineer. Do not remove or refit the appliance onto the backplate without the mains supply to the system being isolated.

All wiring must be in accordance with IEE regulations. This product is for fixed wiring only.

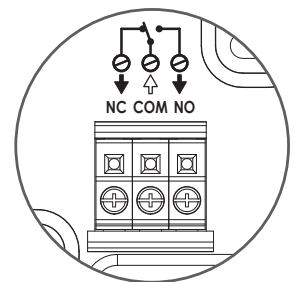
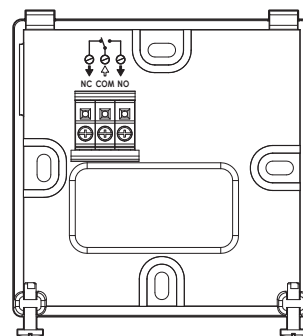

COM = Live
 NC = Normally closed switch out (Satisfied)
 NO = Normally open switch out (call for heat)

MOUNTING OF THE THERMOSTAT

1- Replace the thermostat on the wall mounting plate.

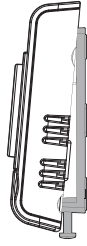

2- Secure the thermostat by screwing the both locking screws under the thermostat.

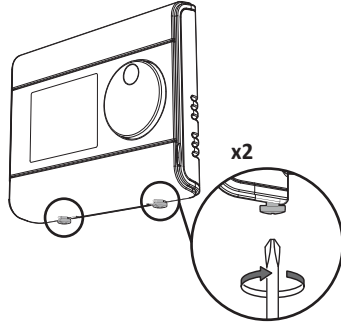

TECHNICAL SPECIFICATIONS

- Power supply: 2 alkaline 1.5 V AA (LR6) batteries.
- Battery life: approx. 2 years.
- Relay outputs: 5(2)A.
- Rated impulse voltage: 4000V.
- Micro disconnection: Type 1B.
- Pollution degree: 2.
- Automatic action: 100,000 cycles.
- Class II.



Note: It is recommended to replace annually as part of the normal system service and before leaving the property empty for a prolonged period.

Environment:

- Operation temperature: 0°C to +40°C.
- Manual temperature setting range: from +5°C to +30°C.
- Storage temperature: from -10°C to +60°C.
- Humidity: 80% at +25°C (without condensation)
- Protection rating: IP30.

Manufactured by: Neomitis Ltd (contact_uk@neomitis.com)

EU declaration of conformity: We hereby declare under our sole responsibility that the products described in these instructions comply with the provisions of Directives and harmonized standards listed below :

- LVD 2014/35/EU : EN60730-1 / EN60730-2-9 / EN62311 ;
- EMC 2014/30/EU : EN60730-1 / EN60730-2-9 ;
- ROHS 2011/65/EU : EN50581 ;

and are manufactured using processes that are certified ISO 9001 : 2008.



The  on the product indicates that you must dispose of it at the end of its useful life at a special recycling point, in accordance with European Directive WEEE 2012/19/EU. If you are replacing it, you can also return it to the retailer from which you buy the replacement equipment. Thus, it is not ordinary household waste. Recycling products enables us to protect the environment and to use less natural resources.

? TROUBLESHOOTING

Display disappears on thermostat.

- Check batteries.
- Replace the 2 batteries. Only use alkaline 1.5V AA (LR6) batteries. Do not use rechargeable batteries.

The heating does not come on or does not go off.

- Your room thermostat may have been set up close to a source of heat or on a cold wall – put it in a recommended location (see the “Installing” section on page 1 for these locations).
- Check that the communication works between the thermostat and the boiler.



www.neomitis.com



NEOMITIS[®]

Creating innovative solutions for ambient comfort

NEOMITIS[®] LIMITED - 4th Floor, Lincoln House, 300 High Holborn, London WC1V 7JH
Registered in England and Wales No: 9543404
Tel: +44 (0) 2071 250 236 - Fax: +44 (0) 2071 250 267 - E-mail: contact_uk@neomitis.com

OPERATING INSTRUCTIONS

WIRED DIGITAL ROOM THERMOSTAT

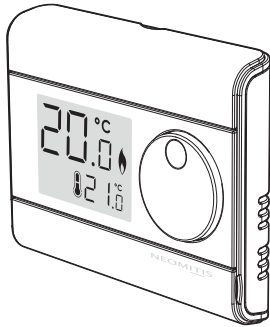
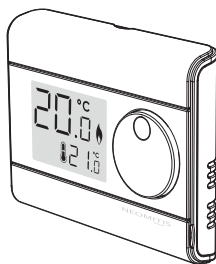

TABLE OF CONTENTS

- Overview..... 1
- Controls and display 1
- Settings 1
 - Initial power up 1
- Operating 1
 - Temperatures setting 1
 - Factory settings 1
- Troubleshooting 2
- Technical specifications 2
- What is a room thermostat..... 2

OVERVIEW

Thank you for purchasing our RTE0A, digital room thermostat. It is by listening to your requirements we have created and designed our products to be easy to operate and install. It is this ease of operation that is intended to make your life easier and help you save energy and money.



CONTROLS AND DISPLAY

• Thermostat

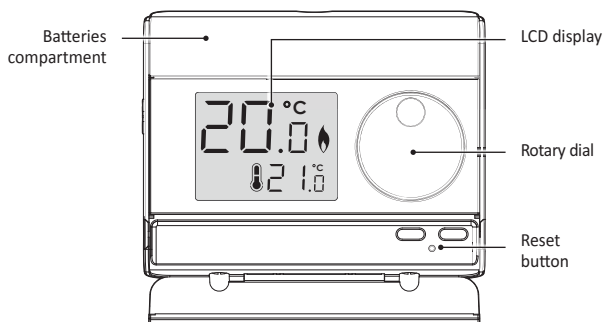

• LCD Display

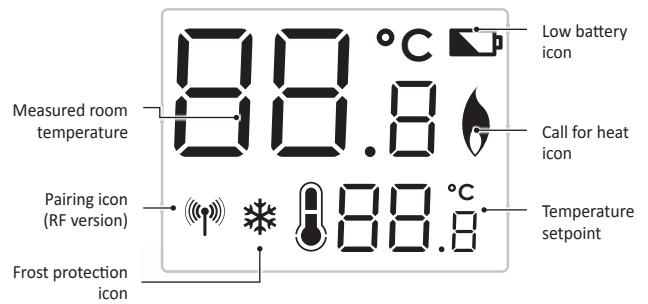

SETTINGS

INITIAL POWER UP

- 1- To start: insert the two AA batteries provided into the battery compartment. Once batteries are fitted all symbols will be displayed on the LCD screen as shown for two seconds.
- 2- After 2 seconds, the LCD will show:
 - The ambient temperature (°C) solid.
 - The icon is solid when the heating is turned ON.
 - The setpoint temperature (°C) solid.



Note: When the batteries must be changed, a low battery level indicator lights up on the device.

Remember to take used batteries to battery collection points so they can be recycled.

OPERATING

TEMPERATURES SETTING

The desired temperature can be set.

To set the temperature, turn the dial clockwise, to increment the temperature, turn the dial counter-clockwise, to decrement the temperature. The default temperature is 20°C (68°F).

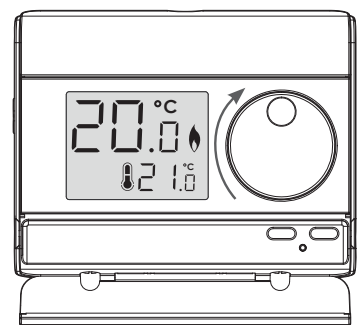

FACTORY SETTINGS

Settings	Factory settings
Set temperature	20°C

Note: To restore factory settings, press and hold down this part for more than 3 seconds using the tip of a pen.

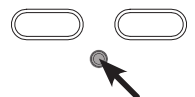

All LCD display will be turned ON for 2 seconds and the factory settings will be restored.

? TROUBLESHOOTING

The boiler is not heating:

- Check that the Thermostat is calling for heat if yes then the thermostat would appear to be working check that the boiler has not switched itself off.
If no increase set temperature.
- Check the position of the batteries. Remove them for 30 seconds and reinsert them. If the problem persists, replace the 2 batteries.

Nothing in the display :

- Check the position of the batteries. Remove them for 30 seconds and reinsert them. If the problem persists, replace the 2 batteries.

The room temperature is not high enough, the boiler is not providing enough heat:

- Check the active desired temperature and increase it if needed (see page 1).

You made a mistake while setting:

- You just need to restore factory settings, as explained in the "Factory settings" section (see page 1). This will reverse any changes you might have made.

The system is not heating but is on:

- If and indicator light is on but the system remains cold, then you should contact your installer.

If the problem persists, then contact your installer.

TECHNICAL SPECIFICATIONS

Please refer to the installing instructions for any informations about batteries life, standards and product environment.

? WHAT IS A ROOM THERMOSTAT



... an explanation for householders

A room thermostat simply switches the heating system on and off as necessary. It works by sensing the air temperature, switching on the heating when the air temperature falls below the thermostat setting, and switching it off once this set temperature has been reached.

Turning a room thermostat to a higher setting will not make the room heat up any faster. How quickly the room heats up depends on the design of the heating system,

for example, the size of boiler and radiators. Neither does the setting affect how quickly the room cools down.

Turning a room thermostat to a lower setting will result in the room being controlled at a lower temperature, and saves energy.

The heating system will not work if a time switch or programmer has switched it off. The way to set and use your room thermostat is to find the lowest temperature setting that you are comfortable with, and then leave it alone to do its job. The best way to do this is to set the room thermostat to a low temperature – say 18°C – and then turn it up by one degree each day until you are comfortable with the temperature. You won't have to adjust the thermostat further. Any adjustment above this setting will waste energy and cost you more money.

If your heating system is a boiler with radiators, there will usually be only one room thermostat to control the whole house. But you can have different temperatures in individual rooms by installing thermostatic radiator valves (TRVs) on individual radiators. If you don't have TRVs, you should choose a temperature that is reasonable for the whole house. If you do have TRVs, you can choose a slightly higher setting to make sure that even the coldest room is comfortable, then prevent any overheating in other rooms by adjusting the TRVs.

Room thermostats need a free flow of air to sense the temperature, so they must not be covered by curtains or blocked by furniture. Nearby electric fires, televisions, wall or table lamps may prevent the thermostat from working properly.



www.neomitis.com



NEOMITIS

Creating innovative solutions for ambient comfort

NEOMITIS[®] LIMITED - 4th Floor, Lincoln House, 300 High Holborn, London WC1V 7JH
Registered in England and Wales No: 9543404

Tel: +44 (0) 2071 250 236 - Fax: +44 (0) 2071 250 267 - E-mail: contact_uk@neomitis.com